

XSEL® Process Gauge - Stainless Steel

Type 232.34 - Dry Case

Type 233.34 - Liquid-filled Case

WIKA Datasheet 23X.34

Applications

- For applications with high dynamic pressure pulsations or vibration a liquid filled case and socket restrictor are available
- Suitable for corrosive environments and gaseous or liquid media that will not obstruct the pressure system
- Process industry: chemical/petrochemical, power stations, mining, on and offshore, environmental technology, mechanical engineering and plant construction

Product features

- Excellent load-cycle stability and shock resistance
- Solid front thermoplastic case
- Positive pressure ranges to 30,000 psi (2,000 bar)
- XSEL® Process Gauge with 5 year warranty on gauge and 10 year warranty on pressure system (see terms and condition)
- All lower mount connection gauges are factory prepared for liquid filling

(LBM: must install membrane prior to field filling)

Specifications

Design

ASME B40.100

Sizes

4½" & 6" (115 & 160 mm) dial size

Accuracy class

± 0.5% of span (ASME B40.100 Grade 2A)

± 1.0% of span (ASME B40.100 Grade 1A)

for ≥ 20,000 psi (1,600 bar) range and above

Ranges

Vacuum / Compound to 400 psi (25 bar)

Pressure from 15 psi (1 bar) to 30,000 psi (2,000 bar)

or other equivalent units of pressure or vacuum

Working pressure

Steady: full scale value

Fluctuating: 0.9 x full scale value

Short time: 1.5 x full scale value

Operating temperature

Ambient: -40°F to +140°F (-40°C to +60°C) - dry

-4°F to +140°F (-20°C to +60°C) - glycerine filled

-40°F to +140°F (-40°C to +60°C) - silicone filled

Medium: max. +212°F (+100°C)



Bourdon Tube Pressure Gauge Model 232.34

Temperature error

Additional error when temperature changes from reference temperature of 68°F (20°C) ±0.4% of span for every 18°F (10°K) rising or falling.

Weather protection

Weather resistant (IP54) - without membrane

Weather tight (IP65) - dry case or filled case with

membrane installed (standard for low mount versions)

Pressure connection

Material: 316L stainless steel

Lower mount (LM) or lower back mount (LBM)

1/4" or 1/2" NPT with M4 internal tap

Restrictor

Material: Stainless steel (0.6 mm), standard

Bourdon tube

Material: 316L stainless steel

≤ 1,000 psi (69 bar): C-shape

≥ 1,500 psi (100 bar): Helical

Movement

Stainless steel

Internal overload stop set at 1.1x full scale

Underload stop-standard

Dampened movement-optional

Dial

White aluminum with black lettering, stop pin at 6 o'clock

Standard WIKA psi single scales (4½" only) with large figures at beginning and end for quick and easy identification.

Pointer

Black aluminum, adjustable

Case

Black fiberglass-reinforced thermoplastic (POCAN)

Solid front, blowout back

Turret-style case with built in rear flange lugs

Window

Clear acrylic with Buna-N gasket

Case filling Type 233.34

Glycerine 99.7% and > 40 psi (2.5 bar)

Glycerine/Water - <= 40 psi (2.5 bar)

Optional extras

- Silicone dampened movement
- Panel mounting adaptor kit (field assembled)
- Silicone case filling
- Halocarbon case filling
- Cleaned for oxygen service
- Instrument glass or safety glass window
- Drag pointer (maximum reading indicator)
- Alarm contacts switches (magnetic or inductive)
- Special process connections
- Custom dial layout
- External zero adjustment (4.5" size only)
- Case and ring in red or yellow thermoplastic (4½" LM only)
- Insight® reflective dial options available in white, fluorescent yellow, fluorescent orange or glow-in-the-dark

Dimensions

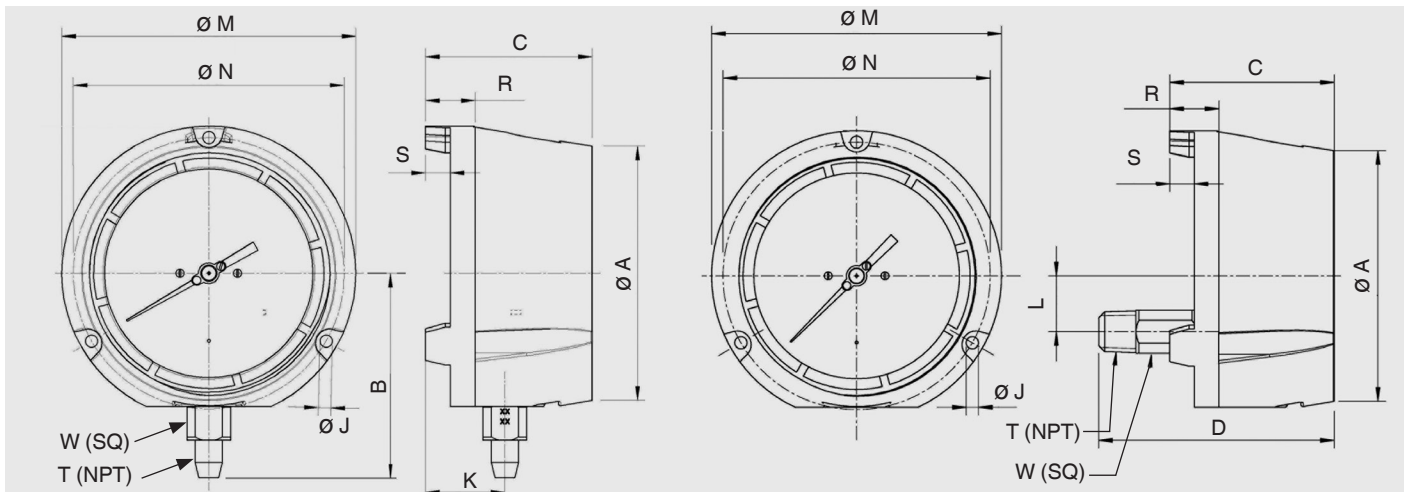

Size		A	B	C	D	J	K	L	M	N	R	S	T	W	Weight ¹	
4.5"	mm	128	103	84	120.3	6.3	40	28.5	148	136.5	25	12.5		22	2 lb.	dry
	in	5	4.06	3.31	4.74	0.248	1.57	1.12	5.83	5.37	0.99	0.49	1/2"	0.87	3 lb.	filled
6"	mm	164	122.5	88	123.4	7.1	40.2	28.5	190	177.8	25.4	12.7		22	3 lb.	dry
	in	6.46	4.82	3.46	4.86	0.28	1.58	1.12	7.5	7	1	0.5	1/2"	0.87	4 lb.	filled

¹ Weight without optional accessories





Quick Order Guide

Specifications according to data sheet
Case
Bezel ring

APM 02.10
Black Fiberglass Reinforced Thermoplastic (Pocan B4225)
Threaded, Black Fiberglass Reinforced Thermoplastic (Pocan B4225)
+/- .5% (ASME B40.100 2A)

Accuracy Class

Ordering information

Measuring System		Stainless Steel					
Case filling		without			with		
Nominal size		4.5"			4.5"		
Process Connection		1/2 NPT		1/4 NPT	1/2 NPT	1/4 NPT	
Connector location							
Scale range	2nd Scale / Special Scale	without	2nd scale kPa	2nd scale kg/cm2	without	without	without
0/15 psi		9834800	9776885	9696479	9834559	9833981	9833808
0/30 psi		9834818	9837680	9696487	9834567	9833999	9833816
0/60 psi		9834826	9776877	9696495	9834575	9834006	9833825
0/100 psi		9834834	9837760	9696509	9834583	9834015	9833833
0/160 psi		9834842	9776869	9696517	9834591	9834023	9833841
0/200 psi		9834850	9837841	9696525	9834605	9834031	9833859
0/300 psi		9834869	9837884	9696534	9834613	9834049	9833867
0/400 psi		9834877	8985116	9696542	9834621	9834057	9833875
0/600 psi		9834885	9837965	9696550	9834630	9834065	9833884
0/1000 psi		9834893	9778918	9696576	9834648	9834074	9833892
0/1500 psi		9834907	9838082	9696585	9793318	9834082	4209827
0/2000 psi		9834915	9838120	9696593	9793661	9834090	4209835
0/3000 psi		9834923	9838163	9696606	9748911	9834104	4209843
0/5000 psi		9834931	9838201	9696615	9793521	9834112	9791919
0/10000 psi		9834940	9838244	9696623	9793679	9834120	50888960
0/15000 psi		9834958	4209860	9696631	50013181	9834138	50399993
-30 inHg/0 psi		9834729	9837604	50322036	9834478	9833914	9833735
-30 inHg/15 psi		9834737	9837566	9696428	9834486	9833922	9833744
-30 inHg/30 psi		9834745	9837523	9696436	9834494	9833930	9833752
-30 inHg/60 psi		52532313	9837485	9696445	9834508	9833948	9833760
-30 inHg/100 psi		9834761	9792818	9696453	9834516	9833956	9833778
-30 inHg/160 psi		9834770	52263436	9696461	9834524	9833965	9833786
-30 inHg/200 psi		9834788	9837361	52219488	9834532	9833973	9833795
-30 inHg/300 psi		4260180	52868970	52909300	4260163	52861267	52849274

	available on stock
	available after production
-	not available

Standard Order Code

		Measuring System
1	3	Stainless Steel
		Case filling
2	2	without
2	3	with
		Nominal size
3	U	4.5"
3	H	6"
		Unit of outer Scale
4	P	psi / -inHg
		Measuring range
5	G	gauge pressure range
5	V	vacuum- or compound-range
		Scale range
	269	0/10 psi
	310	0/15 psi (-30"Hg/0)
	321	0/30 psi (-30"Hg/15 psi)
	341	0/60 psi
	369	0/100 psi
	411	0/160 psi
	414	0/200 psi
	421	0/300 psi
	428	0/400 psi
	441	0/600 psi
	455	0/800 psi
	469	0/1000 psi
	510	0/1500 psi
	514	0/2000 psi
	521	0/3000 psi
	534	0/5000 psi
	541	0/6000 psi
	569	0/10000 psi
	610	0/15000 psi
	331	-30 inHg/30 psi
	352	-30 inHg/60 psi
	379	-30 inHg/100 psi
	412	-30 inHg/160 psi
	415	-30 inHg/200 psi
6	422	-30 inHg/300 psi
		2nd Scale / Special Scale
	Z	without
	B	2nd scale bar
	P	2nd scale psi
	L	2nd scale kPa
	E	2nd scale MPa
7	K	2nd scale kg/cm2

		Process Connection
	ND	1/2 NPT
	GD	G 1/2 B
	NB	1/4 NPT
8	GB	G 1/4 B
		Connector location
	U	lower mount
9	3	lower back mount
		Mounting flange/bracket
	Z	without (standard)
10	Q	Panel Adapter, Stainless Steel, polished
		Window
	A	acrylic (PMMA) (standard)
	G	Flat Instrument Glass
11	H	laminated safety glass
		Restrictor
	Z	Without (standard)
12	Q	stainless steel, D 0.6
		Pointer
13	A	adjustable pointer (standard)
		Set / Drag Pointer
	Z	Without (standard)
	V	Drag pointer Assembly, Permanent Reset Knob
14	W	Drag Pointer Assembly, Removeable Reset Knob
		Special design features
	Z	without (standard)
	G	for Oxygen, Cleanliness ASME B40.1 Level IV
15	N	NACE Sour Gas Service
		Certificates
	Z	without (standard)
16	1	quality certificates
		Approvals
	Z	without (standard)
17	1	with
		Electric alarm contact
	Z	Without (standard)
	A	828.1 Normal Open
	B	828.2 Normal Close
	C	828.11 Normal Open / Normal Open
	D	828.12 Normal Open / Normal Close
	E	828.21 Normal Close / Normal Open
	F	828.22 Normal Close / Normal Close
	G	838.1 Normal Open
	H	838.2 Normal Close
	I	838.11 Normal Open / Normal Open
	J	838.12 Normal Open / Normal Close
	K	838.21 Normal Close / Normal Open
18	L	838.22 Normal Close / Normal Close
		Additional ordering information
	Z	Without (standard)
19	T	Additional text

Modelcode: 1 2 3 4 5 6 7 8 9 10 11 12 13 14 15 16 17 18 19
 2 3 .34 - - - - A -

Additional Text:

Additional scale ranges and options are available. Please contact the factory or access the product configurator for model 232.34 on the WIKA US website.

